

TEST CERTIFICATION

ARTICLE BEAM CLAMP

MODEL BBC-500

DATE OF MANUFACTURE Sep. 19, 2008

CAPACITY 11000 **lbs**

TEST LOAD 16500 **lbs**

RESULT Qualified

INSPECTOR  03

DATE Sep. 19, 2008



OPERATING INSTRUCTIONS

BEAM CLAMP

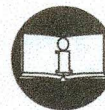
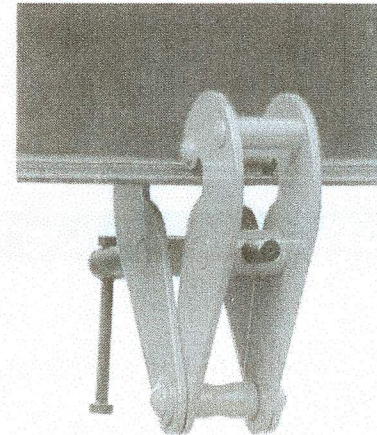

READ THIS MANUAL BEFORE USING THESE PRODUCTS.
This manual contains important safety, operation and maintenance information. Make this manual available to all persons responsible for the operation, installation and maintenance of these products.



1. PLEASE READ THIS MANUAL CAREFULLY BEFORE STARTING TO USE THIS PRODUCT.
2. OVERLOADING IS ABSOLUTELY PROHIBITED.
3. DO NOT WORK UNDER THE LIFTING AREA.

INSTRUCTIONS FOR THE SAFE USE OF BEAM CLAMPS

- Ensure the beam clamp is of the correct capacity for the load being lifted and the support I-beam is engineered to safely hold the load at the attachment point.
- Ensure the beam clamp is fitted correctly over the center of gravity of the item being lifted and so it will not be subjected to **side loading**.
- Before lifting a load ensure that the clamp has been fully tightened and that the lifting device is lifted correct into the eye of the clamp.

IN-SERVICE INSPECTION AND MAINTENANCE

- Ensure that beam clamp is kept clean and moving are parts are lubricated.
- Regularly inspect beam clamps for wear, damage, distortion, cracks or any defect likely to cause a danger.
- If any of the above defects are found, remove the beam clamp from service immediately and refer it to a trained service technician.

SPECIFICATIONS

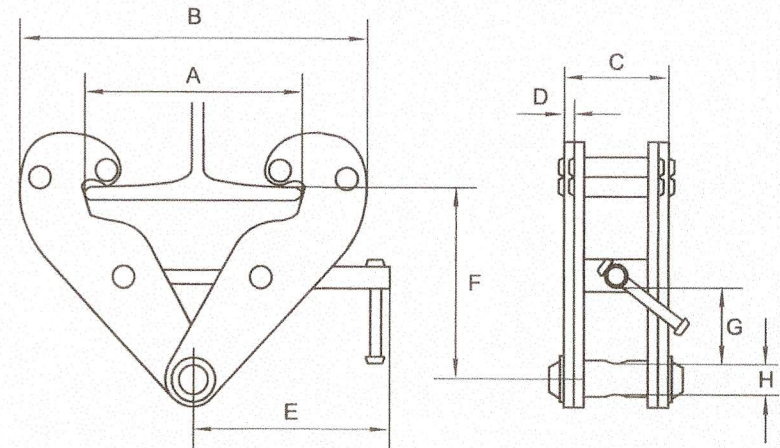

Safety working load lbs	Adjustable beam width in	A		B		C	D	E	F		G	H
		max in	min in	min in	max in				min in	max in		
2,200	2.95-8.66	10.24	7.09	14.17	2.52	0.20	8.46	4.02	6.10	0.99	0.87	
4,400	2.95-8.66	10.24	7.09	14.17	2.91	0.24	8.46	4.02	6.10	0.99	0.87	
6,600	3.15-12.6	13.94	9.25	19.29	4.06	0.32	10.24	5.51	8.86	1.77	0.94	
11,000	3.15-12.6	13.94	9.25	19.29	4.33	0.39	10.24	5.51	8.86	1.77	1.10	
22,000	3.54-12.6	14.37	12.6	19.88	4.72	0.47	11.02	6.69	9.25	1.97	1.57	